

Long Plate Door Hardware

Installation Instructions

Updated June 2016

Passage

Fits doors 1-3/8" to 1-3/4" thick

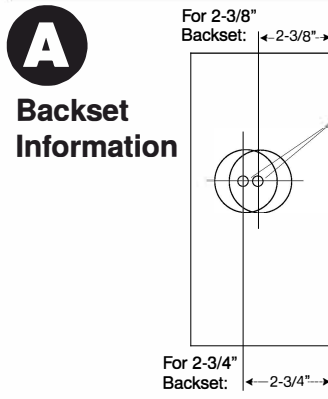

A Backset Information

NOTE:
DRILLING
TEMPLATES ON
SEPARATE
INCLUDED
SHEET

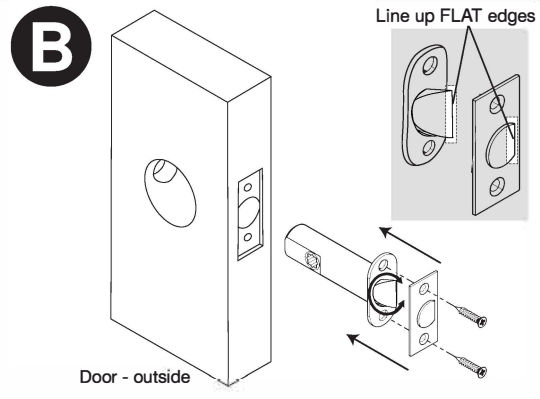

B

Door - outside

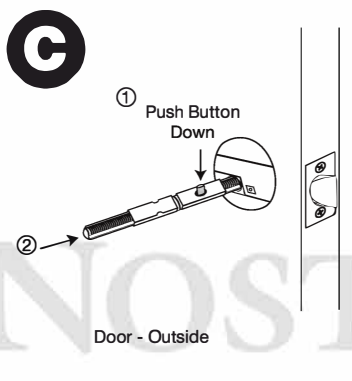

C

Door - Outside

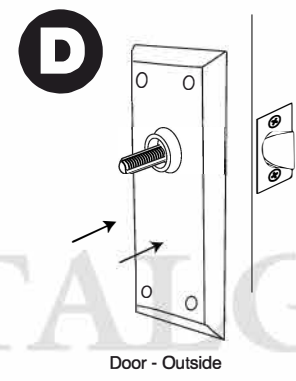

D

Door - Outside

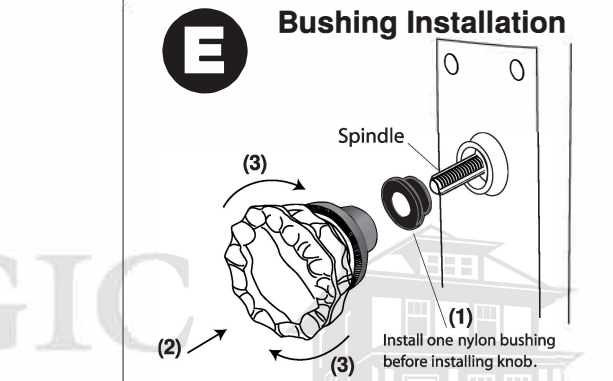

E

Bushing Installation

Install one nylon bushing before installing knob.

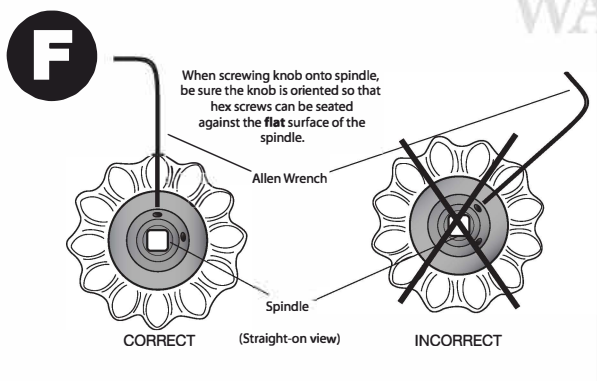

F

CORRECT (Straight-on view)

INCORRECT

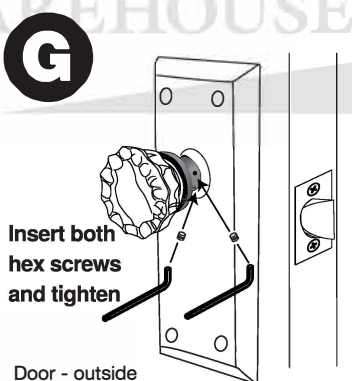

G

Door - outside

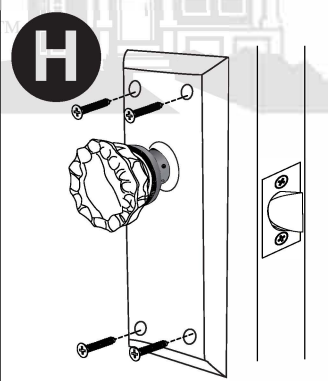

H

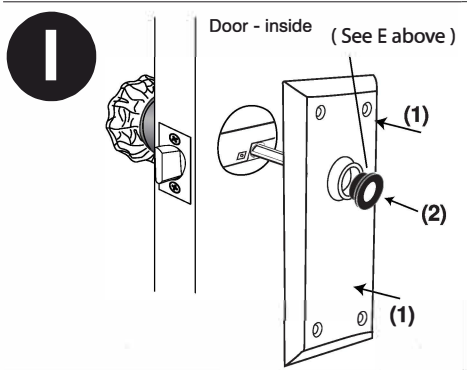

I

Door - inside (See E above)

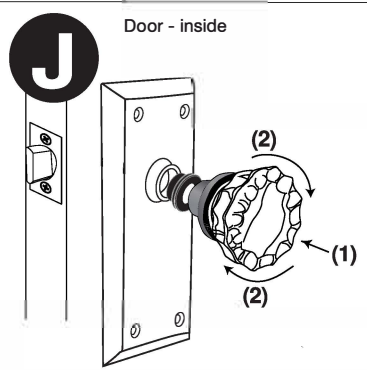

J

Door - inside

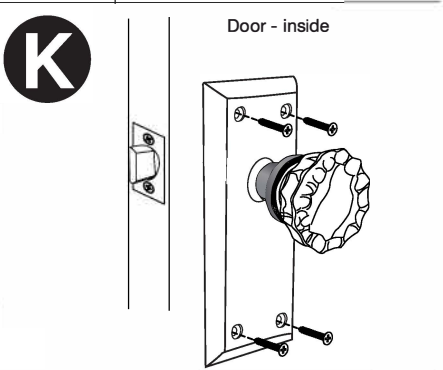

K

Door - inside

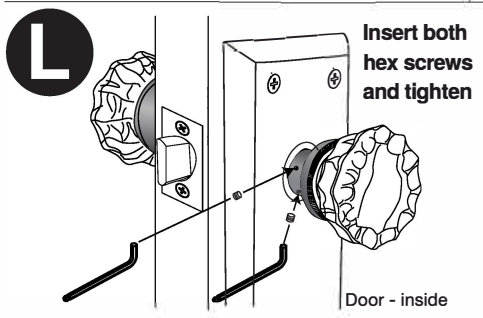

L

Insert both hex screws and tighten

Door - inside

NOTE:
 If knobs do not turn freely;
 loosen one knob and rotate
 counter clockwise for
 1/4 turn, then retighten
 the hex screws.
 Repeat if necessary.

L 6
 P
 200 110K660P77
 K 07
 K 2 01